

Ian McNamee & Partners



7/11 Donald Road Queanbeyan NSW

2 **1** **1**

Rates: \$2,560.96 per annum
Levies: \$726.03 per quarter
Living Size: 103m2 (approx.)
Year of Build: 1985
Potential Rent: \$480 per week

Price : \$499,000 - \$519,000

View : <https://www.mcnamee.com.au/sale/nsw/southern-tablelands/queanbeyan/residential/townhouse/8056347>

Experience the ultimate low maintenance living with this enchanting two-storey townhouse, nestled within a boutique complex of 17 in Queanbeyan. Bathed in morning sunlight, the east-facing living room provides a warm and inviting space to start your day. The well-appointed kitchen and meals area boasts ample storage and modern electric cooking facilities.

Cleverly designed, the townhouse includes under stair storage, a spacious separate laundry room, and a convenient powder room. Step outside to the private paved courtyard, a serene haven requiring minimal upkeep.

Upstairs, the master bedroom features built-in robes, large



Michael Edwards
6283 5555

<https://www.mcnamee.com.au>

7/11 Donald Road, Queanbeyan, NSW 2620

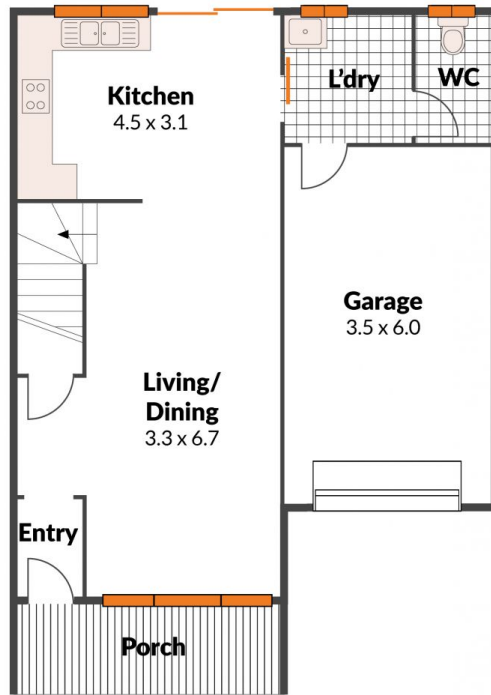

GROUND FLOOR

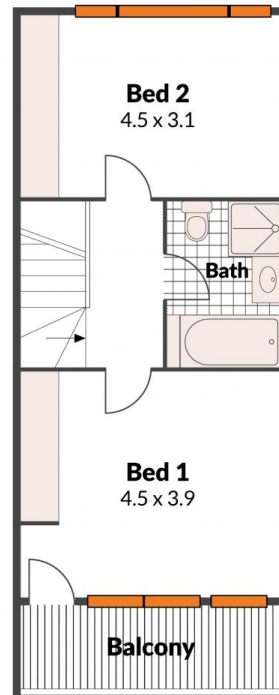

FIRST FLOOR

2 1 1

Ian McNamee & Partners PTY LTD
your local agent

DISCLAIMER: Plans are artist's impressions only and are intended as an approximate guide only. Plans may not be drawn to scale.