

Ian McNamee & Partners



43 Naylor Street Crestwood NSW

4 2 2

Rates: \$3,899.78 per annum

Block Size: 699m²

Current Rent: \$900/week combined

When considering a real estate investment, a dual occupancy property featuring two 2-bedroom units presents an ideal opportunity, particularly in a sought-after location like Crestwood. This type of solid brick construction not only ensures durability but also promises lower maintenance costs in the long run, making it a sound investment.

The design of the property is tailored for both comfort and practicality. Single-level living offers ease of access and caters to a broader range of tenants. The easy-care grounds further enhance the appeal, requiring minimal upkeep and adding to the property's attractiveness as a rental.

Location is always key in real estate, and being within

Price : \$789,000 - \$829,000

Land Size : 699 sqm

View : <https://www.mcnamee.com.au/sale/nsw/capital-monaro-snowy/crestwood/residential/house/8099585>



Darren Bennett
02 6283 5555

43 Naylor Street, Crestwood, NSW 2620

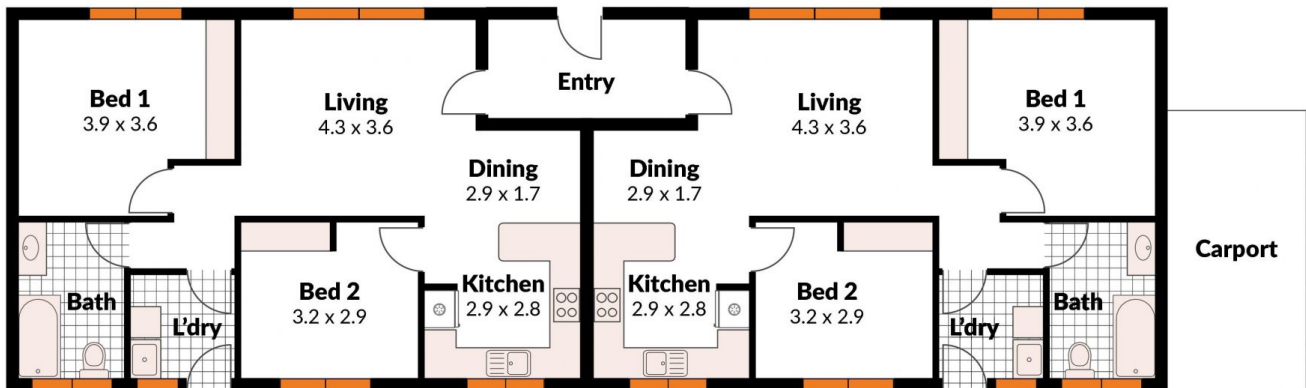

4  2  1 

Ian McNamee & Partners ^{PTY LTD}
your local agent

DISCLAIMER: Plans are artist's impressions only and are intended as an approximate guide only. Plans may not be drawn to scale.